

copper apple box



description

Meet the newest generation of the Apple Box in copper with a unique matte-black finish. This abd signature piece was initially inspired by the all-purpose wooden crates used on film-sets, often called apple boxes. Over the years, Ashley has reinterpreted its basic geometric form in exotic wood, stone and various metals, elevating its appeal as a simple yet elegant modernist object. Its welded construction is sturdy enough to be used as an occasional chair. Two side hand holes, reminiscent of the original inspiration, have rolled edges for soft handling.

Each table has been finished using a chemically bonding organic process to capture the fluidity and motion of water. The resulting pattern cannot be repeated, ensuring that no two tables are exactly alike.

Made to order and handcrafted in Toronto

materials

organic finish in copper

dimensions

height: 12" (30.5cm)

width: 16" (40.6cm)

depth: 16" (40.6cm)

shipping and delivery

This item is made to order and ready to ship within 6 to 8 weeks after purchase.

ASHLEY
BOTTEN
DESIGN

copper apple box

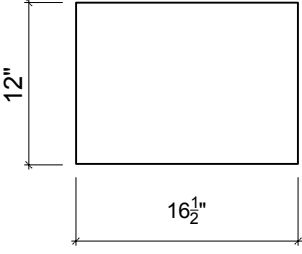

PLAN

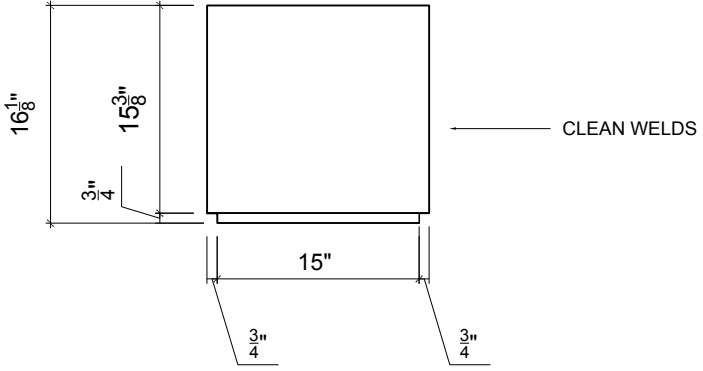

FRONT

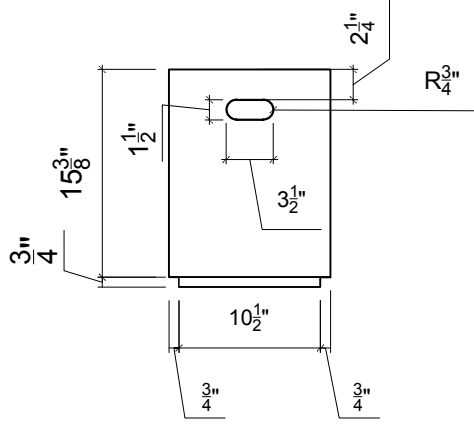

SIDE

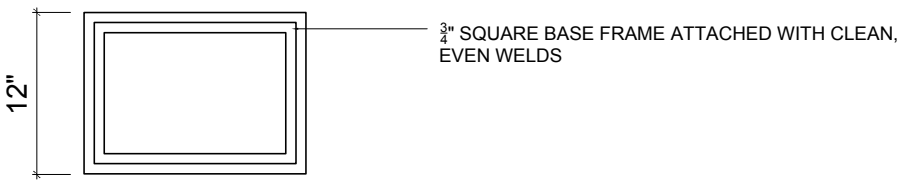

UNDERSIDE

72 stafford street, suite 100 . toronto, ontario m6j 2r9
416.203.9363 . concierge@ashleybottendesign.com

ashleybottendesign.com